

MakersLED MakersDRIVER™

Part: MakersDRV1.2

Quick Start Guide

Incorrect Power Polarity Will Blow the Fuse!
Power off before making connections!

Power off before making connections!

- 1x **Green** Jack: Power, 48V DC input
- 2x **Blue** Jacks: 2 LED Channels, Connect LEDs
- 1x **Black** Jack: 0-10V Lighting Control Input
- 2x Audio-Style Jack: MakersCONTROLLER control
- 1x **White** 3 Pin Connector: One 12V DC fan

Includes: MakersDRIVER, Mounting Hardware, Cable tie (to secure fan cable) & jumper

1. Prepare the 48V Power Supply (PSU)

Confirm the line voltage switch (110v/220v), confirm the DC output Voltage. See your PSU manual.

Install LDD Drivers

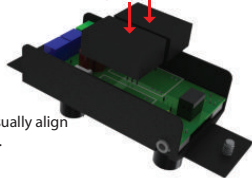

2. Install Meanwell LDD Drivers into CH1DRIVER and CH2DRIVER sockets

Notice one corner has 3 pins instead of 2. Visually align all the pins in the sockets and push squarely.

3. Test it!

Minimize variables by attaching only one LED on each channel to start. Once you see it's working add more LEDs.

How Many LEDs on each Blue Jack?

Given 48v DC input, the MakersDRIVER can drive up to 45V of LEDs
#LEDs = 45V/LED Voltage (see vendor product page for LED voltage)

Safety & Disclaimer: You are the builder and you are responsible for all aspects of safety on your build. *Static Electricity:* Discharge yourself before handling electronics. *Salt Spray:* Do not allow water splash or salt spray to come into contact with the MakersDRIVER.



Get the Full MakersDRIVER Manual at:
www.MakersLED.com/support

MakersLED MakersCONTROLLER™

Part: MakersCTR1.02

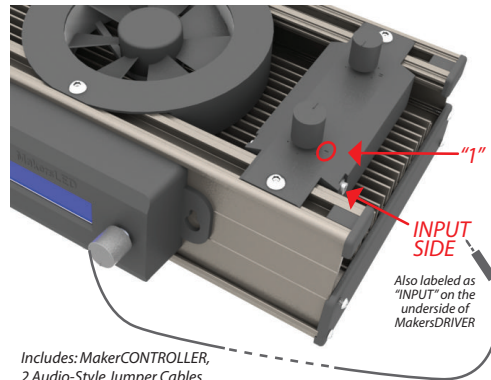

Includes: MakerCONTROLLER, 2 Audio-Style Jumper Cables

Quick Start Guide

1. Install **MakersDRIVER** according to users manual. Apply 48V power.

2. Install **MakersCONTROLLER:** Plug the tethered audio-style cable into the MakersDRIVER input labeled "INPUT" jack on the MakersDRIVER.

For multiple MakersDRIVERS, use the included cables to daisy chain the output to preceding input connections on MakersDRIVERS. Optionally, install the jumper onto "CH3&4" pins of the MakersDRIVER to make the default CH1&2 become CH3&4 to the MakersCONTROLLER.

Note: If the Input/Output connections are not correct, the MakersCONTROLLER will not power and/or will not pass data to preceding MakersDRIVERS.

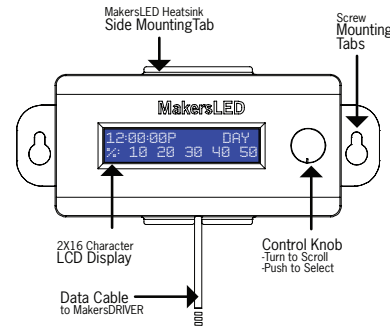

Get the Manual at: www.MakersLED.com/support

Safety & Disclaimer: You are the builder and you are responsible for all aspects of safety on your build. *Static Electricity:* Discharge yourself before handling electronics. *Salt Spray:* Do not allow water splash or salt spray to come into contact with the MakersDRIVER/CONTROLLER.

